

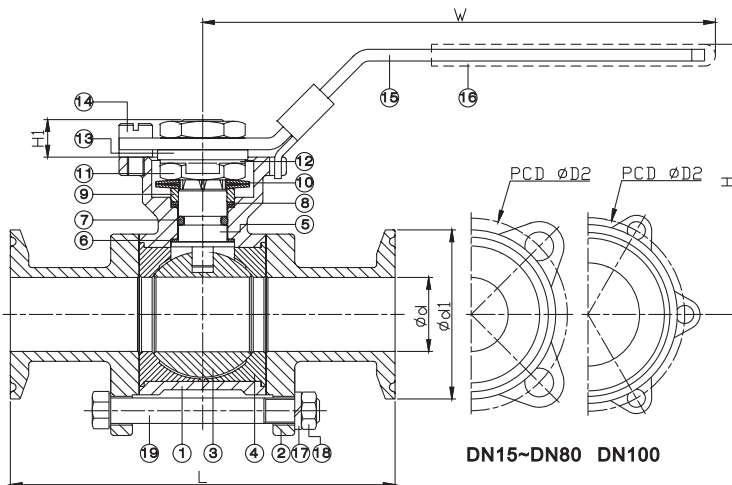

FEATURES

- Clamp end, 1/2"~4" (DN15~DN100)
- Body W.P. : 1000 WOG (PN63)
- Clamp End W.P. : 200 WOG
- W.T. : -20°C~200°C (-4°F~392°F)
- Investment casting
- Blow-out proof stem
- Live-loading device
- Cavity filled seats (option)
- Locking device
- ISO 5211 Direct mounting pad
- **Automation accessories (option)**

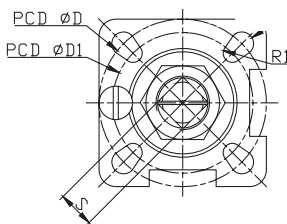

ITEM	PARTS	MATERIAL	
1	BODY	ASTM A351-CF8M	ASTM A351-CF3M
2	CAP		
3	BALL	ASTM A276-316	
4	SEAT	PTFE / TFM1600	
5	STEM	ASTM A276-316	
6	THRUST WASHER	PTFE	
7	O-RING	VITON	
8	PACKING	PTFE	
9	GLAND RING	AISI 304	
10	BELLEVILLE WASHER	AISI 301	
11	NUT	AISI 304	
12	LOCKING WASHER		
13	FLAT WASHER		
14	STOP PIN		
15	HANDLE	PVC	
16	HANDLE SLEEVE		
17	SPRING WASHER	AISI 304	
18	NUT		
19	BOLT		

DN	D	D1	D2	d	d1	R	R1	S	L	H	H1	W	Torque (N·M)	
													Breakaway	Action
15	42	36	45.5	9.6	25.4	2.75	2.75	9	90.7	121.3	9	64.7	5	2.5
20	42	36	47	15.8	25.4	2.75	2.75	9	103	121.3	11	64.7	7.5	3.5
25	50	42	57.5	22.1	50.5	3.5	2.75	11	115	150	11	79	11	6
40	70	50	83	34.8	50.5	4.5	3.5	14	139	150	14	96.5	16	11
50	70	50	100	47.7	64	4.5	3.5	14	158	180	14	104	20	13
65	102	70	126	60.3	77.5	5.5	4.5	17	197	180	17	142	40	25
80	102	70	148	72.9	91	5.5	4.5	17	228	243.5	17	150	50	30
100	125	102	183	97.5	119	6.5	5.5	22	241.8	285	22	185	60	40

unit: mm

NPS	D	D1	D2	d	d1	R	R1	S	L	H	H1	W	Torque (in·lb)	
													Breakaway	Action
1/2"	1.65	1.42	1.79	0.38	1	0.11	0.11	0.35	3.57	4.78	0.35	2.55	44.25	22.13
3/4"	1.65	1.42	1.85	0.62	1	0.11	0.11	0.35	4.06	4.78	0.43	2.55	66.38	30.98
1"	1.97	1.65	2.26	0.87	1.99	0.14	0.11	0.43	4.53	5.91	0.43	3.11	97.36	53.1
1 1/2"	2.76	1.97	3.27	1.37	1.99	0.18	0.14	0.55	5.47	5.91	0.55	3.8	141.61	97.36
2"	2.76	1.97	3.94	1.88	2.52	0.18	0.14	0.55	6.22	7.09	0.55	4.09	177.01	115.06
2 1/2"	4.02	2.76	4.96	2.37	3.05	0.22	0.18	0.67	7.76	7.09	0.67	5.59	354.03	221.27
3"	4.02	2.76	5.83	2.87	3.58	0.22	0.18	0.67	8.98	9.59	0.67	5.91	442.54	265.52
4"	4.92	4.02	7.2	3.84	4.69	0.26	0.22	0.87	9.52	11.22	0.87	7.28	531.04	354.03

unit: in

