



3-PC. BUTT WELD END BALL VALVE

2012D



FEATURES

- Full port, 2-1/2"~4" (DN65~DN100)
 - W.P. : 1000 WOG (PN63)
 - W.T. : -20°C~200°C (-4°F~392°F)
 - Investment casting
 - Blow-out proof stem
 - Live-loading device
 - Anti-static device
 - Locking device
 - ISO 5211 Direct mounting pad
 - **Automation accessories (option)**
- Butt weld ends conform to ANSI B16.25 & DIN 3239 part1

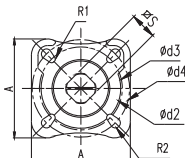

FOR DN65 -100

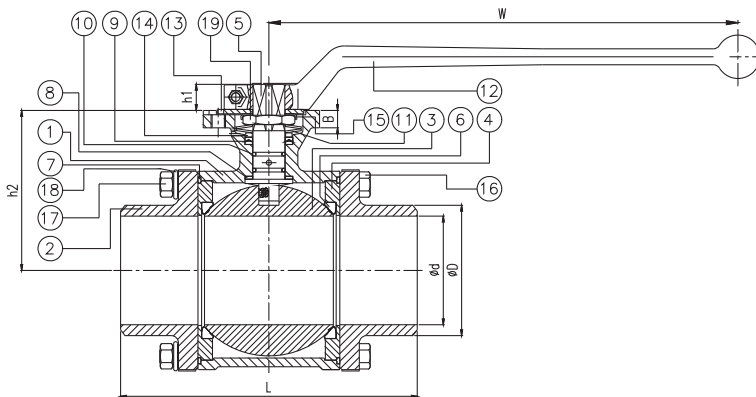

ITEM	PARTS	MATERIAL	
1	BODY	ASTM A351-CF8M	ASTM A216-WCB
2	CAP		
3	BALL	ASTM A351-CF8M	
4	SEAT RETAINER	ASTM A276-316	
5	STEM	RTFE	
6	BALL SEAT	PTFE	
7	SEAL	VITON	
8	THRUST WASHER	AISI 301	
9	PACKING	ASTM A351-CF8M	
10	O-RING	AISI 304	
11	BELLEVILLE WASHER	AISI 304	
12	HANDLE	AISI 304	
13	LOCKING DEVICE	AISI 304	
14	GLAND RING	AISI 304	
15	LOCKING WASHER	AISI 304	
16	BOLT	AISI 304	
17	NUT	AISI 304	
18	SPRING WASHER	AISI 304	
19	STEM NUT	AISI 304	

DN	d	D	L	W	ISO 5211	A	B	S	h1	h2	d2	d3	d4	R1	R2	Torque (N-M)		Weight kg
																Breakaway	Action	
65	65	74	170	325	F07/F10	100	10	17	17	105	70	70	102	4.5	5.5	89.18	30.55	9.87
80	76	90	180	325						111.5						65	13.18	
100	100	115	189	325	F10/F12	125	12	22	22	136	100	102	125	5.5	6.5	116	70	23.6

unit:mm

NPS	d	D	L	W	ISO 5211	A	B	S	h1	h2	d2	d3	d4	R1	R2	Torque (in-lb)		Weight lb
																Breakaway	Action	
2-1/2"	2.56	2.91	6.69	12.8	F07/F10	3.94	0.39	0.67	0.67	4.13	2.76	2.76	4.02	0.18	0.22	789.31	270.39	21.76
3"	2.99	3.54	7.09	12.8						4.39						575.3	29.06	
4"	3.94	4.53	7.44	12.8	F10/F12	4.92	0.47	0.87	0.87	5.35	3.94	4.02	4.02	0.22	0.26	1026.68	619.55	52.03

unit:in



8F., No.201, Sec. 2, Tiding Blvd., Neihs District, Taipei City 114, Taiwan R.O.C.
 TEL: +886-2-26585800 FAX: +886-2-26582266 / 27997766

[Http://www.haitima.com.tw](http://www.haitima.com.tw)
 Email: haitima@seed.net.tw