



# 3-PC. SOCKET WELD END BALL VALVE

# 2011M



## FEATURES

- Full port, 1/4"~4" (DN8~DN100)
- W.P. : 1000 WOG (PN63)
- W.T. : -20°C~200°C (-4°F~392°F)
- Investment casting
- Blow-out proof stem
- Anti-static device (option)
- Locking device
- ISO 5211 Mounting pad

- Socket weld ends conform to  
ANSI B16.11 & DIN 3239 part2

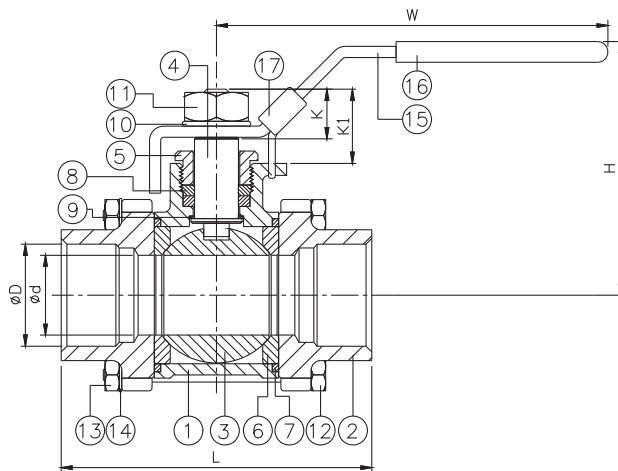
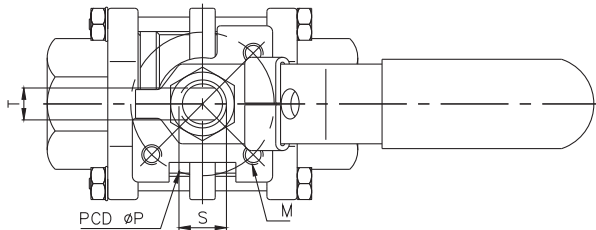

ITEM	PARTS	MATERIAL	
1	BODY	ASTM A351-CF8M	ASTM A216-WCB
2	CAP		
3	BALL	ASTM A351-CF8M	
4	STEM	ASTM A276-316	
5	GLAND NUT	AISI 304	
6	SEAT	PTFE / RTFE	
7	SEAL		
8	PACKING	PTFE	
9	THRUST WASHER		
10	SPRING WASHER		
11	STEM NUT		
12	BOLT	AISI 304	
13	BOLT NUT		
14	SPRING WASHER		
15	HANDLE		
16	HANDLE SLEEVE	PVC	
17	LOCKING DEVICE	AISI 304	

DN	d	D	L	H	W	P	M	T	K	K1	S	Torque (N-M)	Weight (kg)
8	11.6	14	64.5	54	119	36	M 5	5	10.5	15.2	5/16"UNC	4	0.4
10	12.7	18	64.5	54	119	36	M 5	5	10.5	15.2	5/16"UNC	4	0.4
15	15	22	66	57	119	36	M 5	5	10.5	16.2	5/16"UNC	4	0.58
20	20	27.6	84	63	135	36	M 5	6.5	13.5	20.7	3/8"UNC	7	0.75
25	25	34.5	95	81	158	42	M 5	8	15.5	24.7	7/16"UNC	7.5	1.08
32	32	43	111	86	158	50	M 5	8	15.5	21.7	7/16"UNC	11	1.85
40	38	49	130	96	188	50	M 6	9	17.5	27.6	1/2"UNC	17	2.6
50	50	61.5	151	109	198	70	M8	9	17.5	26.7	1/2"UNC	45	3.94
65	65	74	183	133	280	102	M12	12	33	42.2	3/4"UNC	59	8.06
80	80	90	210	149	320	102	M12	12	33	40.2	3/4"UNC	90	13.35
100	100	115.5	234	171	312	102	M12	16	42	58	1"UNC	160	24.55

unit:mm

NPS	d	D	L	H	W	P	M	T	K	K1	S	Torque (in-lb)	Weight (lb)
1/4"	0.46	0.55	2.54	2.13	4.69	1.42	M 5	0.2	0.41	0.6	5/16"UNC	35	0.88
3/8"	0.50	0.71	2.54	2.13	4.69	1.42	M 5	0.2	0.41	0.6	5/16"UNC	35	0.88
1/2"	0.59	0.87	2.6	2.24	4.69	1.42	M 5	0.2	0.41	0.64	5/16"UNC	35	1.28
3/4"	0.79	1.09	3.31	2.48	5.31	1.42	M 5	0.26	0.53	0.81	3/8"UNC	62	1.65
1"	0.98	1.36	3.74	3.19	6.22	1.65	M 5	0.31	0.61	0.97	7/16"UNC	66	2.38
1-1/4"	1.26	1.69	4.37	3.39	6.22	1.97	M 5	0.31	0.61	0.85	7/16"UNC	97	4.08
1-1/2"	1.5	1.93	5.12	3.78	7.4	1.97	M 6	0.35	0.69	1.09	1/2"UNC	150	5.73
2"	1.97	2.42	5.94	4.29	7.8	2.76	M8	0.35	0.69	1.05	1/2"UNC	398	8.69
2-1/2"	2.56	2.91	7.2	5.24	11.02	4.02	M12	0.47	1.3	1.66	3/4"UNC	522	17.77
3"	3.15	3.54	8.27	5.87	12.6	4.02	M12	0.47	1.3	1.58	3/4"UNC	797	29.44
4"	3.94	4.55	9.21	6.73	12.28	4.02	M12	0.63	1.65	2.2	1"UNC	1416	54.13

unit:in



8F., No.201, Sec. 2, Tiding Blvd., Neihu District, Taipei City 114, Taiwan R.O.C.  
TEL: +886-2-26585800 FAX: +886-2-26582266 / 27997766

[Http://www.haitima.com.tw](http://www.haitima.com.tw)  
Email: [haitima@seed.net.tw](mailto:haitima@seed.net.tw)